

WOLF RAILING

FLAT RAIL INSTALLATION GUIDE

Adhere to local building codes and principles when installing Wolf Railing. All installations are unique and the sole responsibility of the installer to determine specific requirements for each application. Wolf claims no liability or responsibility for the improper installation of this product. Wolf recommends that all designs be reviewed by a licensed engineer, architect, and/or local building inspector before installation.

STEP 1

Unbox your section of railing, making sure you have all parts and pieces needed for assembly.

STEP 2

Place the bottom rail across the opening where the railing is to be installed. Allowing at least 1 ¼" from the end of the bottom rail to the first baluster hole, adjust your measurements until each end is equal. If the baluster hole is less than 1 ¼", shift rail to the left or right until spacing is even again. Mark your measurements onto the rail ⅛" short to allow for expansion.

STEP 3

Making sure your measurements are correct, transfer your marks onto the top rail by laying the bottom and top rails together with the baluster holes lined up to one another.

STEP 4

Cut each end of the bottom and top rails according to your measurements made in Steps 3-4. A circular or miter saw is recommended. (NOTE: The top rail has an aluminum "P" channel inside for added support. Leave this channel in when cutting the top rail.)

STEP 5

Place the bottom mounting brackets onto the bottom rail at each end, making sure the flat side is facing the mounting surface and install crush block(s) in holes in bottom. (None in 4' & 5' kits, one in 6', two in 8', three in 10'.)

STEP 6

Cut spacer blocks from scrap to use under bottom rail to set height.

Bottom rail space for 36" finished height:

- Traditional or Designer Rail with square or colonial balusters = 3 ½"
- Traditional or Designer Rail with 32" Deckorators Classic balusters = 2 ½"
- Undrilled Designer Rail with Deckorators 32 ¼" Arc or Baroque balusters = 2 ¼"
- Undrilled Designer Rail with Deckorators 26" Scenic Clear View balusters = 3"

STEP 7

Place bottom rail on top of the spacer blocks from Step 2 as support and slide the brackets up to the mounting surface. Pre-drill each screw hole (1/8" drill bit) before securing the bracket in place to the mounting surface using the screws provided.

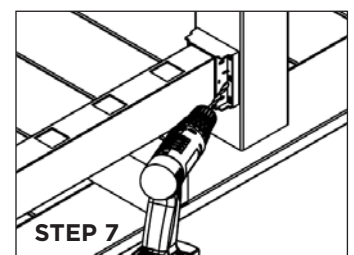
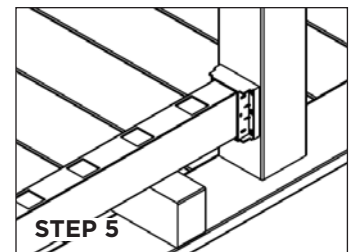
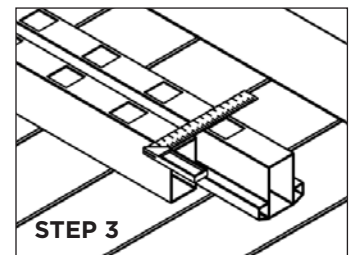
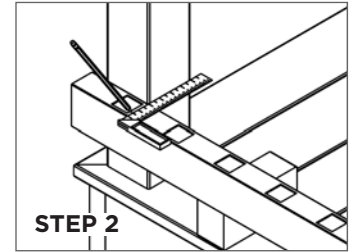

WOLF HOME PRODUCTS®

WOLF RAILING

FLAT RAIL INSTALLATION GUIDE

STEP 8

Insert each baluster into the holes of the bottom rail.

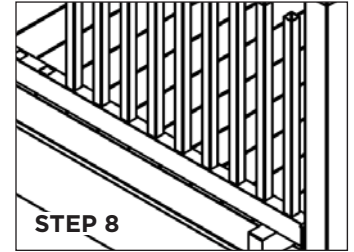

STEP 9

Place the top mounting brackets onto each end of the top rail, making sure the flat side is facing the mounting surface.

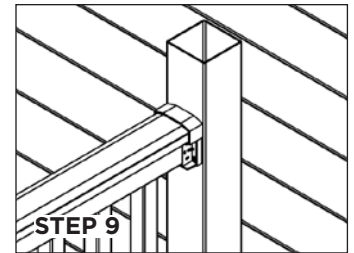

STEP 10

Starting at one end of the railing section, insert each baluster into the matching hole of the top rail.

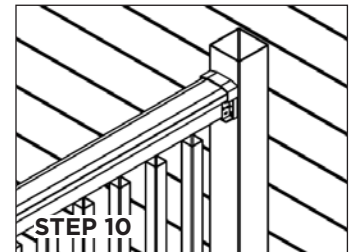

STEP 11

Secure the top rail brackets by pre-drilling each screw hole and using the screws provided.

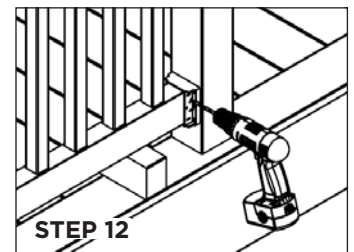

STEP 12

Each bracket set contains 2 set screws with screw covers. Pre-drill through the top of each bottom bracket into the bottom rail and through the bottom of each top bracket into the top rail. Secure the screws into place.

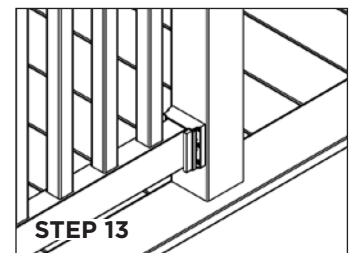

STEP 13

Check your installation for accuracy before snapping the decorative screw covers of each bracket into place.

